

FICHE D'HOMOLOGATION
HOMOLOGATION FORM

Homologation N°

297 / M / 09



COMMISSION INTERNATIONALE
DE KARTING - FIA



MOTEUR / ENGINE
FA

Constructeur	Manufacturer	IAME S.P.A. – ZINGONIA (I)
Marque	Make	PARILLA
Modèle	Model	REEDJET - MAXI
Type d'admission	Inlet type	CLAPETS
Durée de l'homologation	Validity of the homologation	9 ans / 9 years
Nombre de pages	Number of pages	6

Formattato: Italiano (Italia)

La présente Fiche d'Homologation reproduit descriptions, illustrations et dimensions du moteur au moment de l'homologation CIK-FIA. Le Constructeur a la possibilité de les modifier seulement dans les limites fixées par le règlement CIK-FIA en vigueur. La hauteur du moteur complet sur les photos doit être de 7cm minimum.

This Homologation Form reproduces descriptions, illustrations and dimensions of the engine at the moment of the CIK homologation. The Manufacturer may modify them, but only within the limits fixed by the CIK-FIA regulations in force. The height of complete engines on all photos must be minimum 7cm.

Formattato: Inglese (Gran Bretagna)

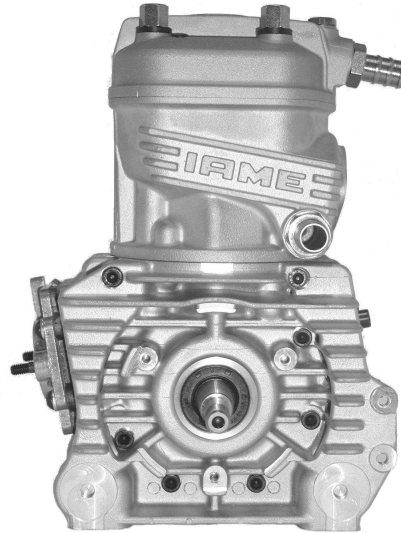
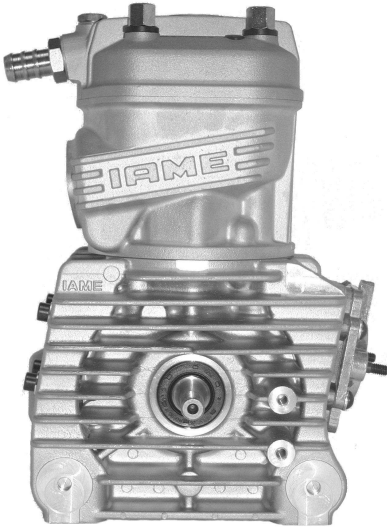

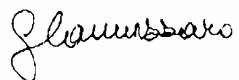



PHOTO DU MOTEUR CÔTÉ PIGNON
PHOTO OF DRIVE SIDE OF ENGINE

PHOTO DU MOTEUR CÔTÉ OPPOSÉ
PHOTO OF OPPOSITE SIDE OF ENGINE

Formattato: Inglese (Gran Bretagna)

Signature et tampon de l'ASN Signature and stamp of the ASN	Signature et tampon de la CIK-FIA Signature and stamp of the CIK-FIA
 	 

Formattato: Inglese (Gran Bretagna)

Formattato: Inglese (Gran Bretagna)

Formattato: Inglese (Gran Bretagna)

Codice campo modificato

INFORMATIONS TECHNIQUES		TECHNICAL INFORMATION	
A	CARACTÉRISTIQUES	A	CHARACTERISTICS
			Tolérances
Volume du cylindre	<i>Cylinder volume</i>	99.31 CM3	< 100cm³
Alésage d'origine	<i>Original bore</i>	49.94 MM	
Alésage théorique maximum	<i>Theoretical maximum bore</i>	50.11 MM	
Course	<i>Stroke</i>	50.7 MM	
Système de refroidissement	<i>Cooling system</i>	WATER COOLED	
Nombre de systèmes de carburation	<i>Number of carburation systems</i>	1	
Longueur (entre-axe) de la bielle	<i>Length between the axes of the connecting rod</i>	100 MM	±0.1mm
Modifications autorisées selon le Règlement Technique. Seules les dimensions et cotes qui ne peuvent pas être modifiées doivent figurer sur la Fiche d'Homologation.			
<i>Modification allowed according to the Technical Regulations. Only the dimensions and readings which may not be changed must be mentioned on the Homologation Form.</i>			

Formattato: Inglese (Gran Bretagna)

Formattato: Inglese (Gran Bretagna)

C	MATÉRIAU	C	MATERIAL
Cylindre	<i>Cylinder</i>		AL - SI (GALS I 9) / FONTE
Culasse	<i>Cylinder head</i>		AL - SI (GALS I 9)
Carter	<i>Sump</i>		AL - SI (GALS I 9)
Bielle	<i>Connecting rod</i>		ACIER CR - MO

Formattato: Inglese (Gran Bretagna)

Formattato: Inglese (Gran Bretagna)

Codice campo modificato

DESSIN DU DÉVELOPPEMENT DU CYLINDRE

DRAWING OF THE CYLINDER DEVELOPMENT

Formattato: Inglese (Gran Bretagna)

Formattato: Inglese (Gran Bretagna)

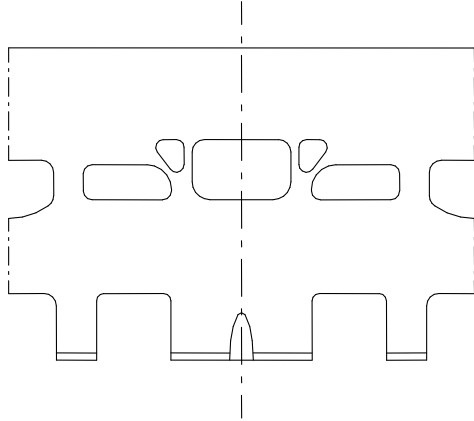
DESSIN DU PIED DU
CYLINDREDRAWING OF THE
CYLINDER BASEVUE EN SECTION DU
CYLINDRECYLINDER SECTION
VIEW

Formattato: Inglese (Gran Bretagna)

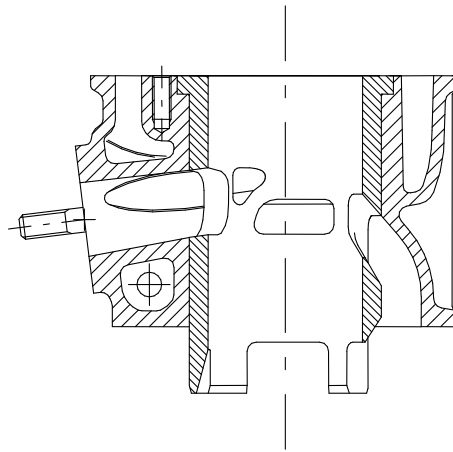
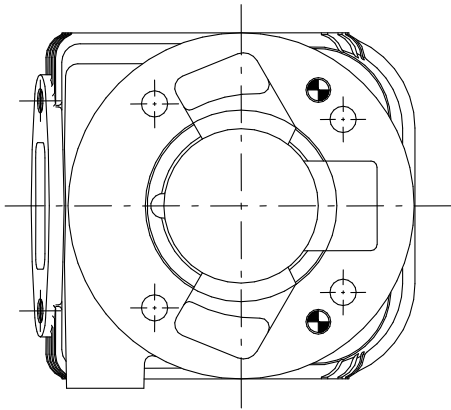

Formattato: Inglese (Gran Bretagna)

Formattato: Inglese (Gran Bretagna)

Codice campo modificato

DESSIN DE LA CULASSE ET DE LA CHAMBRE DE COMBUSTION

DRAWING OF THE CYLINDER HEAD AND OF THE COMBUSTION CHAMBER

Formattato: Inglese (Gran Bretagna)

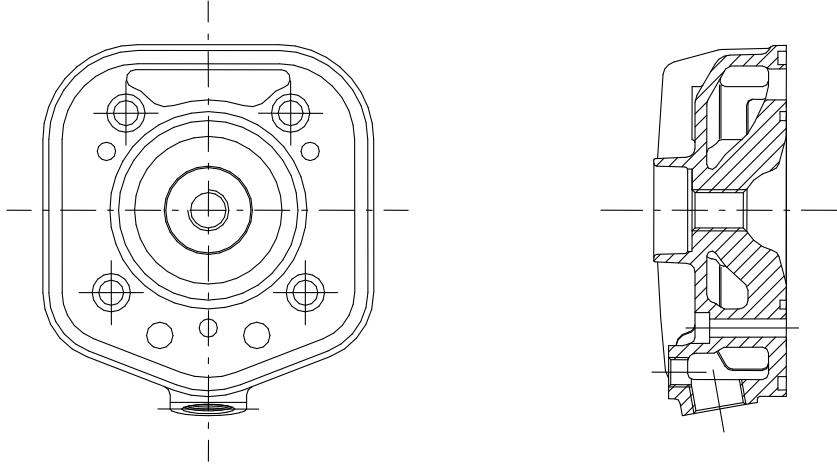

DESSIN DU VILEBREQUIN

DRAWING OF THE CRANKSHAFT

DESSIN INTÉRIEUR DU CARTER

DRAWING OF THE INSIDE OF SUMP

Formattato: Inglese (Gran Bretagna)

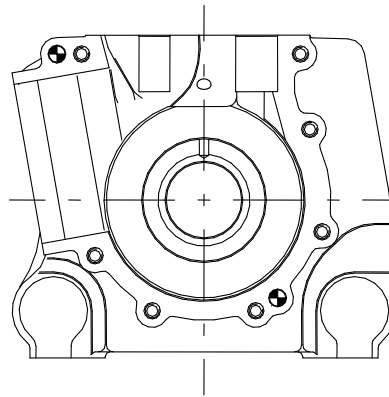
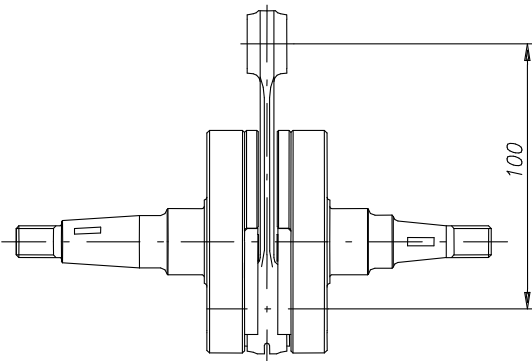

Formattato: Inglese (Gran Bretagna)

Formattato: Inglese (Gran Bretagna)

Codice campo modificato

PHOTO DE L'ARRIÈRE
DU MOTEUR*PHOTO OF THE BACK
OF THE ENGINE*PHOTO DE L'AVANT
DU MOTEUR*PHOTO OF THE
FRONT OF THE
ENGINE***Formattato:** Inglese (Gran
Bretagna)**Formattato:** Inglese (Gran
Bretagna)PHOTO DU MOTEUR
PARTIE SUPÉRIEURE*PHOTO OF THE
ENGINE TAKEN
FROM ABOVE*PHOTO DU MOTEUR
PARTIE INFÉRIEURE*PHOTO OF THE
ENGINE TAKEN FROM
BELOW***Formattato:** Inglese (Gran
Bretagna)**Formattato:** Inglese (Gran
Bretagna)**Formattato:** Inglese (Gran
Bretagna)**Formattato:** Inglese (Gran
Bretagna)**Codice campo modificato**

PHOTO DU PIED DU CYLINDRE	PHOTO OF THE BASE OF THE CYLINDER	PHOTO DU CARTER (CÔTÉ JOINT)	PHOTO OF THE SUMP (GASKET SIDE)
			

Formattato: Inglese (Gran Bretagna)

Formattato: Inglese (Gran Bretagna)

Formattato: Inglese (Gran Bretagna)

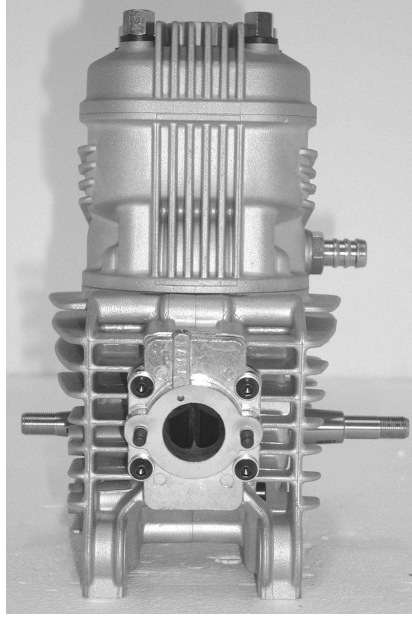
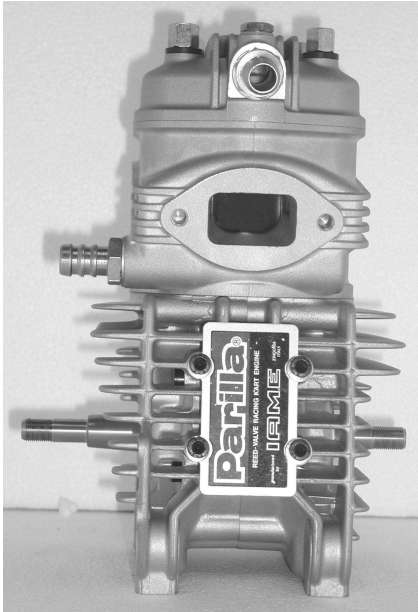
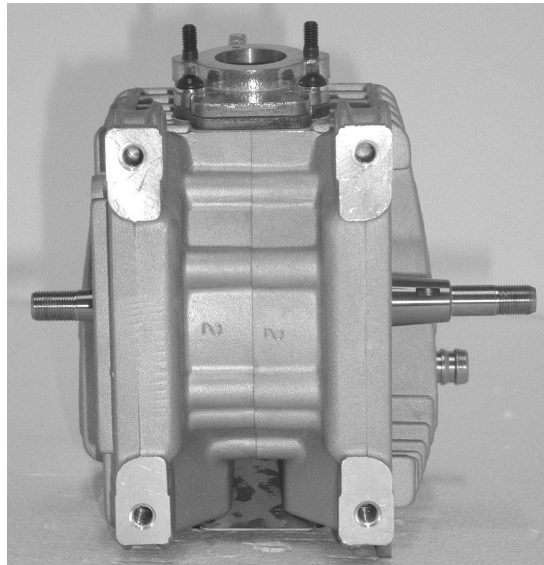
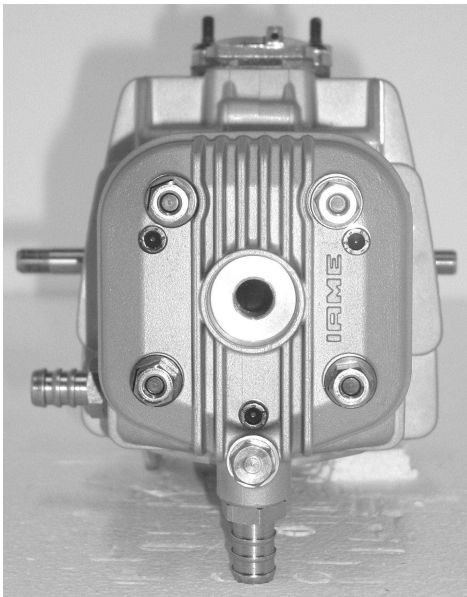
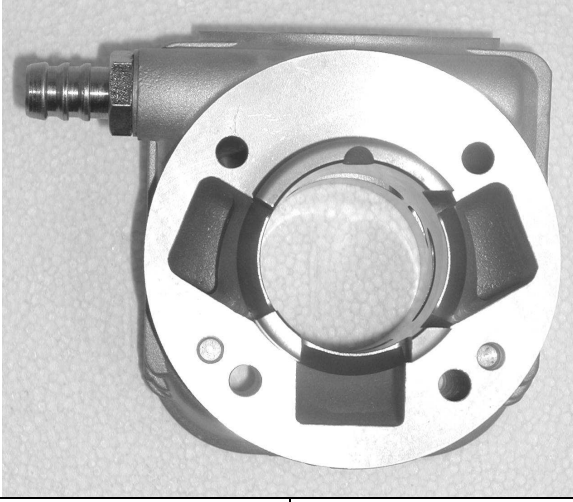
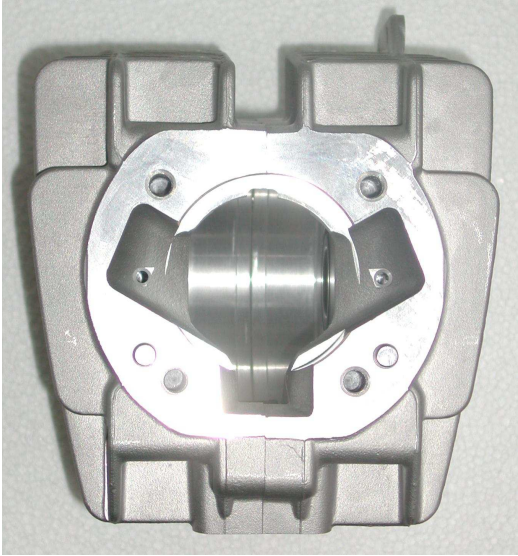
Formattato: Inglese (Gran Bretagna)

Codice campo modificato